

EDGETAK User Manual



a HEICO company

EDT | Engineering Design Team, Inc.

3423 NE John Olsen Avenue
Hillsboro, OR 97124 USA

<https://edt.com/>

Document revision: 1.1
Model: 095-16200-EDGETAK

This page intentionally left blank



Warnings and Restrictions

- Overvoltage will damage the device. **DO NOT** apply more than 16V on the 12V input pins.
- Not FCC tested.
- Not tested by any safety agency.
- Intended for use with approved battery, AC adapter, or car adapter (up to user's discretion).
- User serviceable modules should only be serviced by trained technicians following instructions.
- Unit must be assembled with properly installed Thermal Interface Material (TIM)
- Disassembly or alterations to the enclosure may reduce the effectiveness of dust and water resistance.
- Do not reprogram with any operating system other than the EDT-provided board support package.
- Do not submerge in liquid.
- Do not allow enclosure vents to become covered or clogged.
- Intended for vertical use (connectors and faceplate pointed upwards) and/or with airflow.
- Not intended for operation in ambient temperatures over 45 ° C. See Power Mode Table.
- Store in temperatures between 18°C and 30°C for long term, or -40°C and 85°C for short term.
- We do not recommend disabling SOM protection capabilities.
- Designed for IP54, protection against dust ingress and splashes of water.
- Requires adequate ventilation to achieve maximum processing capability.
- Do not subject to high impact forces.
- Unless explicitly stated otherwise, this product and its accompanying documentation are subject to EDT's Terms of Use:

<https://edt.com/downloads/edt-terms-use/>



EDT | Engineering Design Team, Inc.
3423 NE John Olsen Avenue, Hillsboro, OR 97124 USA
<https://edt.com/>

Disclaimers

Engineering Design Team (EDT) provides the enclosed product under the following conditions:

This device is for evaluation purposes. Persons handling this product must have electronics training and observe good engineering practices. The enclosed device does not fall within the scope of the European Union directives regarding electromagnetic compatibility, restricted substances (RoHS), recycling (WEEE), FCC, CE or UL, and therefore may not meet the technical requirements of these directives or other related directives.

Warranty information: EDT standard warranty. <https://edt.com/downloads/edt-warranty/>

The user assumes all responsibility and liability for proper and safe handling of the product. Further, the user indemnifies EDT from all claims arising from the handling or use of the product. Due to the accessibility of the circuitry in this device, it is the user's responsibility to take any and all appropriate precautions with regard to static discharge. Except to the extent of the indemnity set forth above, neither party shall be liable to the other for any indirect, special, incidental, or consequential damages.

EDT assumes **no liability for applications assistance, customer product design, software performance, or infringement of patents or services described herein.**

Please read the User's Guide and, specifically, the Warnings and Restrictions notice in this document prior to handling the product. This notice contains important safety information about temperatures and voltages.

No license is granted under any patent right or other intellectual property right of EDT covering or relating to any machine, process, or combination in which such EDT products or services might be or are used.

FCC Warning

This device is intended for evaluation purposes only and is not considered by EDT to be the final end product for customer use. It may generate or use and can radiate radio frequency energy and has not been tested for compliance with the limits of computing devices pursuant to part 15 of FCC rules, which are designed to provide reasonable protection against radio frequency interference. Operation of equipment in other environments may cause interference with radio communications, in which case the user at his own expense will be required to take whatever measures may be required to correct this interference.

EDT | Engineering Design Team, Inc.

3423 NE John Olsen Avenue, Hillsboro, OR 97124 USA

<https://edt.com/>



Overview

- User provides 12V DC supply
 - 9-16V DC input
 - Max. current draw 6.0A at 12V in
 - Recommended battery capacity 2.5Ah per 1 hour of intended intensive use or 1Ah per 1 hour of intended low load use (no intensive processing or data recording)
- Product dimensions: 88mm x 54mm x 213mm
- Weight: 2.35lbs/1.1kg
- Power connector for custom cable assembly
- Two SMA connectors available for connecting antennas to M.2 E-Key card
 - User must connect internal coax cable to the M.2 card
 - If the desired M.2 card has incompatible antenna connectors, user must replace internal coax cables with IP67 rated SMA cables
- 1x 1GbE port
- 2x USB Type C

For adequate cooling:

- Enclosure is recommended to be used in a vertical position with airflow.
- It should not be used for intensive processing in a small, enclosed space with little airflow.
- If the device is used in high ambient temperatures or for processing heavy loads, it may throttle to protect itself.

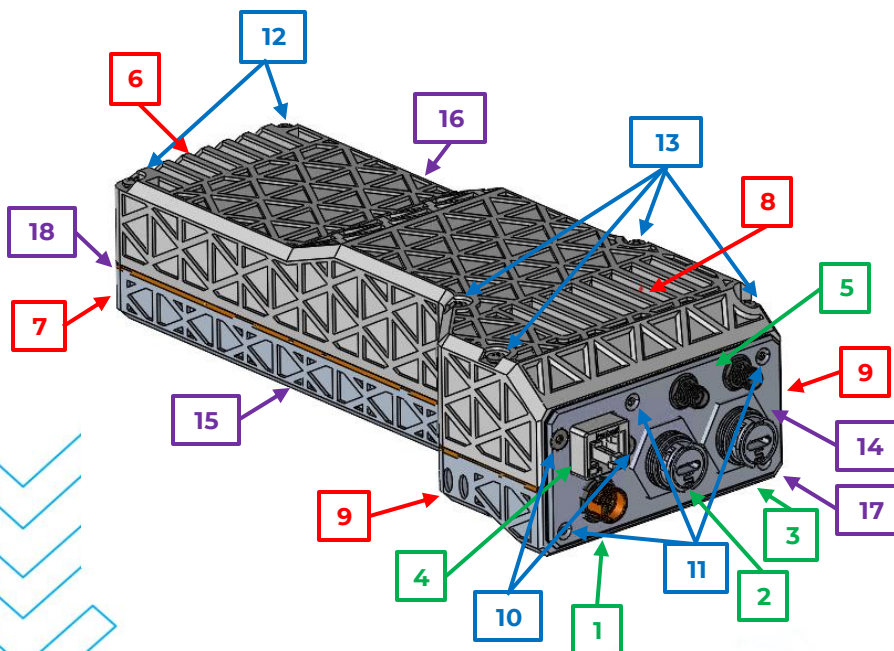

1. Power inlet connector
2. USB Connector 2 (Recovery Prog.)
3. USB Connector 1 (DisplayPort)
4. Ethernet
5. 2x SMA connectors for E-key antennas
6. Ventilation – intake, module side
7. Ventilation – intake, component side
8. Ventilation – exhaust, module side
9. Ventilation – exhaust, component side
10. 2x screws, T8 Torx head, 4-40 14"
11. 4x screws, T8 Torx head, M3.5x0.45
12. 2x screws, Phillips, M2.5x0.45 30mm
13. 4x screws, Phillips, M2.5x0.45 35mm
14. Face plate
15. Enclosure, component side
16. Enclosure, module side
17. Faceplate gasket
18. Enclosure gasket



EDT | Engineering Design Team, Inc.

3423 NE John Olsen Avenue, Hillsboro, OR 97124 USA
<https://edt.com/>

Included in Package

EDGETAK unit

- NVIDIA Jetson Orin™ NX 16GB SOM (already programmed, need DisplayPort display with USB-C adapter to create login)
- Samsung EVO 990 2TB NVMe SSD (Jetson Linux + BSP already flashed)
- SMA Cables 2x 200mm long IP67 to AMC (U.FL, MHF) connector for user antenna (must install E-key card and plug cables into card!)
- Unit comes with single-end-terminated power cable, user adds desired connector
- 2x USB cables BCU-C-S-1.00-UC-P

Does not include:

- M.2 E-Key Wireless card
- Antennas
- Power source and its connector
- Ethernet cable
- DisplayPort adapter

Replacement Part Kits

Item	Part #
Screws	094-16229
Power Cable	016-16206
Faceplate	017-16179
Gaskets	094-16230
USB Cable	016-16183
SOM/SSD	094-16231

EDT | Engineering Design Team, Inc.

3423 NE John Olsen Avenue, Hillsboro, OR 97124 USA

<https://edt.com/>



To Access Modules

Tools Required:

- Phillips screwdriver
- T8 Torx driver
- Thermal Interface Material (TIM) (reuse* or replace)
- Gaskets (reuse* or replace)

**only reuse TIM and Gaskets that are in good working condition.*

When inserting a screw into aluminum threads, always turn the screw backwards by hand first until it drops into the existing threads. Inserting a screw and beginning to tighten it, by hand or with an electric driver, may strip the threads in the aluminum

- Remove at least the top two Torx screws with T8 size driver from the faceplate
- Remove six outer screws from larger half of the enclosure with Phillips screwdriver

! DO NOT CROSS-THREAD SCREWS !

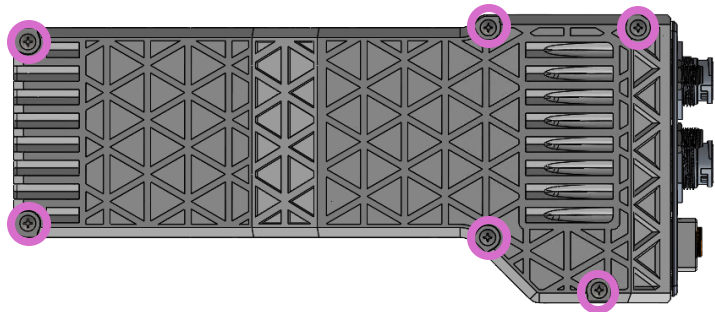
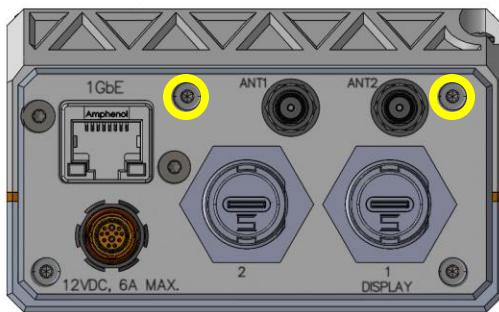

- Remove the screw(s) for the chosen module using a Phillips screwdriver

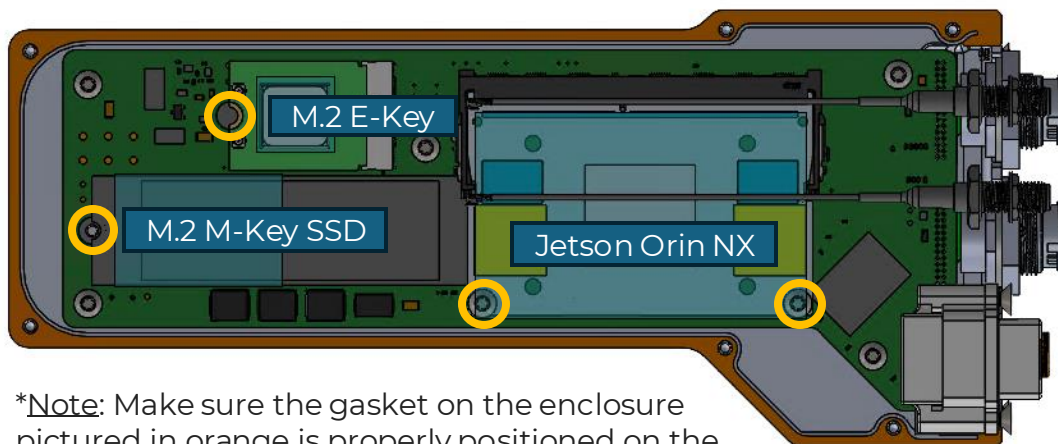

Note: Make sure the gasket on the enclosure pictured in orange is properly positioned on the module side before closing



EDT | Engineering Design Team, Inc.
3423 NE John Olsen Avenue, Hillsboro, OR 97124 USA
<https://edt.com/>

To Remove Modules

M.2 E-key:

- Carefully disconnect any antenna cables that are connected with an [appropriate tool](#).
- Unscrew one Phillips screw and remove M.2 card.

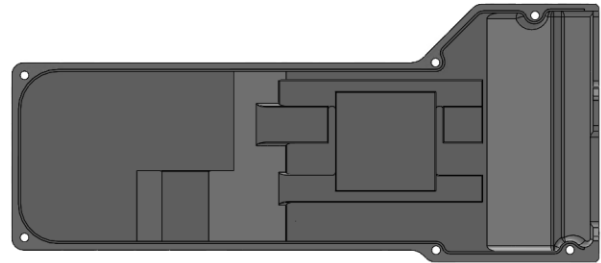

Kapton Tape
Under M.2 E-Key

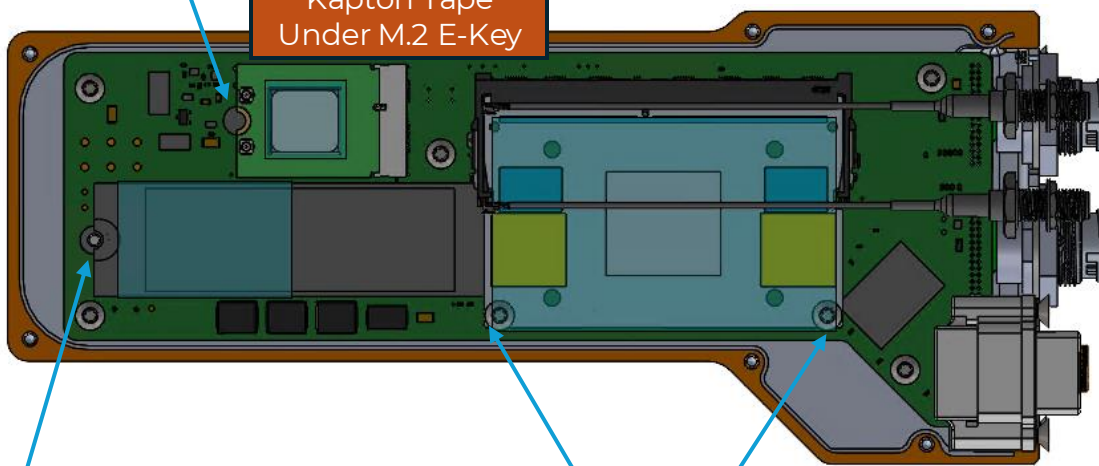

M.2 M-Key SSD:

- Unscrew one Phillips screw and remove card.

Orin NX:

- Unscrew 2x Phillips screws from standoffs (standoffs remain installed).
- Nudge the side arms out by a small amount and the Orin will be released.
- Remove Orin NX module.

Replacing Modules

- Read connector manufacturer's insertion instructions.
- Be sure each module is fully seated and even.
- Ensure there is Kapton tape under the E-Key card to avoid shorts.
- Replace all TIM according to the instructions in this document.
- Route the SMA cables so they are not damaged when the enclosure is sealed or interfere with any TIM.
- Make sure gasket is adhered to the component half (smaller side) of the enclosure along the provided inner lip and that the screw holes are clear.
- Install 4 module screws.
- Add TIM (minimum Orin NX chip in middle and SSD)
 - *Ensure that the protective plastic is removed from BOTH sides of the TIM.*
- Install 6 long screws to seal enclosure.
- Install 4 T8 screws to affix the faceplate to the two assembled enclosure halves (with gasket adhered to the back of faceplate – ensure that screw holes are clear).

TIM (Thermal Interface Material) Instructions

- Sites 'a' through 'q', each with specific min and max thickness and size.
- Install TIM onto modules.

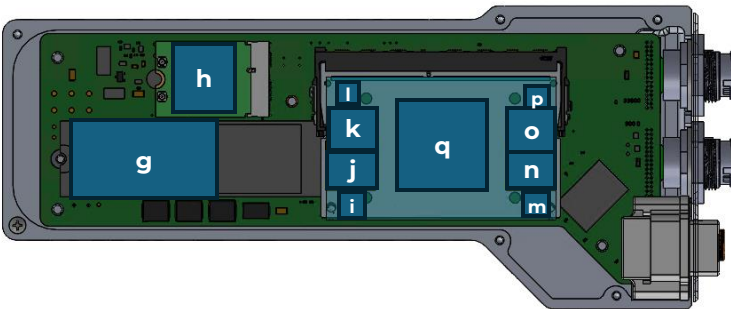

	Thick (mm)	Dim. mm ²
g	2.5	40 x 22
h	1	16 x 22
i, m	2	5 x 5
j, n	1	14 x 14
k, o	2	10 x 7
l, p	4	optional
q	1	23x21

Make sure to remove plastic cover from BOTH SIDES of TIM before application!!

Gasket must be properly installed to preserve any environmental protection!



EDT | Engineering Design Team, Inc.
3423 NE John Olsen Avenue, Hillsboro, OR 97124 USA
<https://edt.com/>

M.2 E-Key (Customer Supplied)

- User provides antenna and E-key card.
- Always cover the PCB under the M.2 E-Key module with Kapton tape before use to avoid shorts.
- Can replace SMA connectors with other to match E-key connectors.
 - Alternate or replacement SMA cables EDT suggests:
 - SMA to AMC 200mm from [Amphenol 336319-12-0200](#) (used by EDT)
 - SMA to AMC4 200mm from [Amphenol 095-902-502-200](#)
 - SMA to MHF 200mm from [Amphenol 095-902-585-200](#)
- Wi-Fi/Bluetooth card tested:
 - [Intel Wi-Fi 6 AX200 \(Gig+\)](#)
- GPS card that exists:
 - [Auvideo M.2 Key B/E GPS module](#) Model# 70899
- Reference antenna connector compatibility chart below

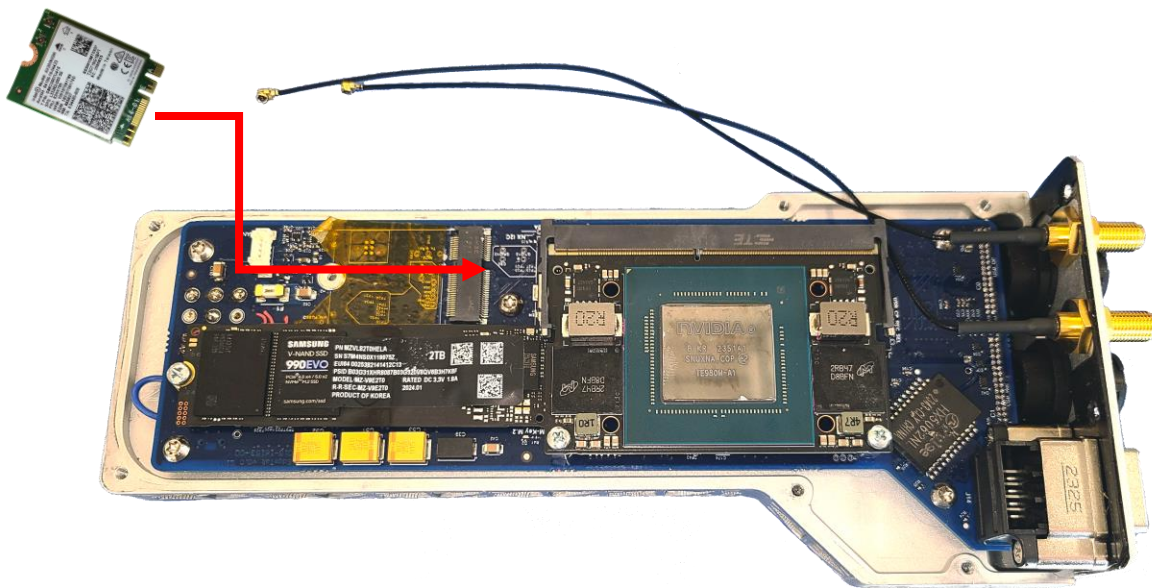

Antenna Connector Compatibility			
	PCB Footprint	Mated Height	Compatibility
AMC	3 mm x 3 mm	2,5 mm	Hirose U.FL. IPEX MHF
AMC4	2 mm x 2 mm	1.4 mm	IPEX MHF4
AMMC	2 mm x 2 mm	1,4 mm	Hirose W.FL. IPEX MHF3

USB Type-C connectors

Connector 1

- USB 3.2, up to 10 Gbps
- DisplayPort over USB-C (DP Alt Mode)
- USB PD sources power up to 7.5W / 5.0V \approx 1.5A

Connector 2

- USB 3.2, up to 10 Gbps
- Recovery Programming port (short jumper J8)
- USB PD sources power up to 7.5W / 5.0V \approx 1.5A

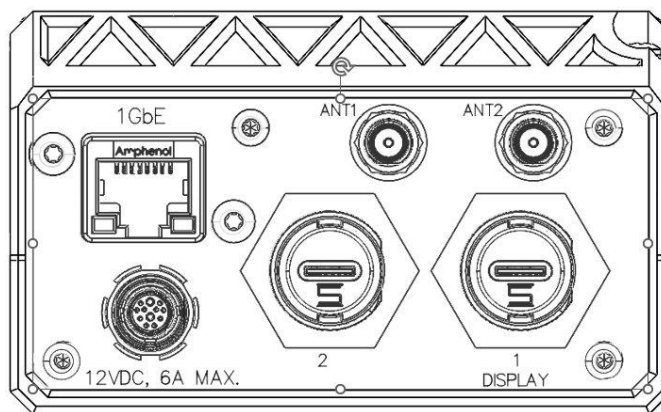
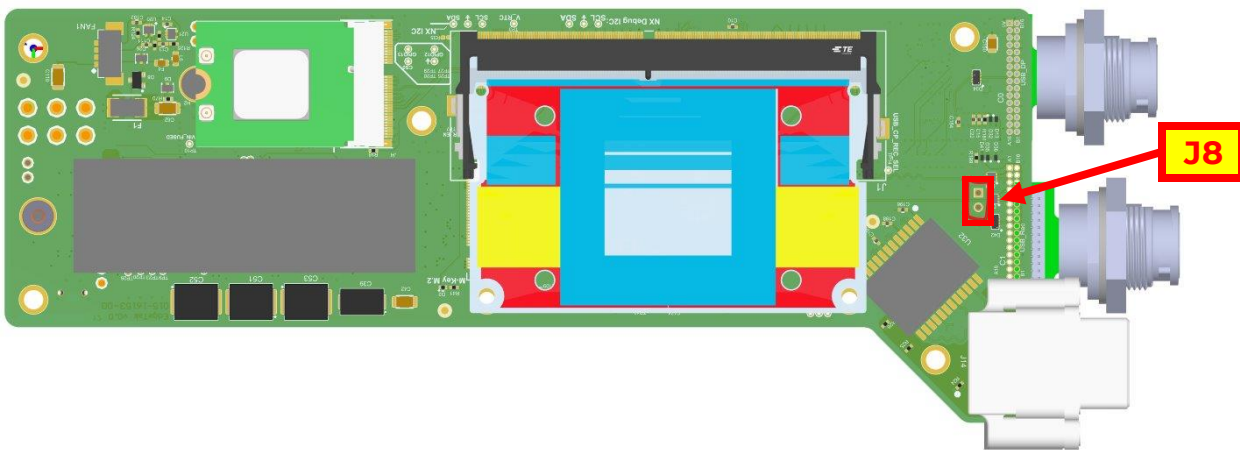

Once programmed, Display is used to create login – only the first time after install

- Connect DisplayPort display through USB Connector1 using an adapter or dock that supports DP Alt Mode.
- Using GUI, finish OS setup and create username and password.
- Then the device can be accessed via the graphical desktop, remotely over SSH, or locally with serial UART.



USB C and DisplayPort adapters tested



To use DisplayPort:

- Framework DisplayPort Adaptor (2nd gen) - <https://frame.work/products/displayport-2nd-gen-expansion-card>
- UGREEN NVMe Enclosure, model CM559 - <https://www.ugreen.com/products/ugreen-m-2-nvme-sata-ssd-enclosure-adapter>
- VisionTek VT2000 USB-C Dock, model 901284 - <https://visiontek.com/products/vt2000-triple-display-usb-c-docking-station-with-power-passthrough>

EDT | Engineering Design Team, Inc.

3423 NE John Olsen Avenue, Hillsboro, OR 97124 USA

<https://edt.com/>



Cable Mount Connector – 1meter pigtail

Pins 1, 10 are No Connect

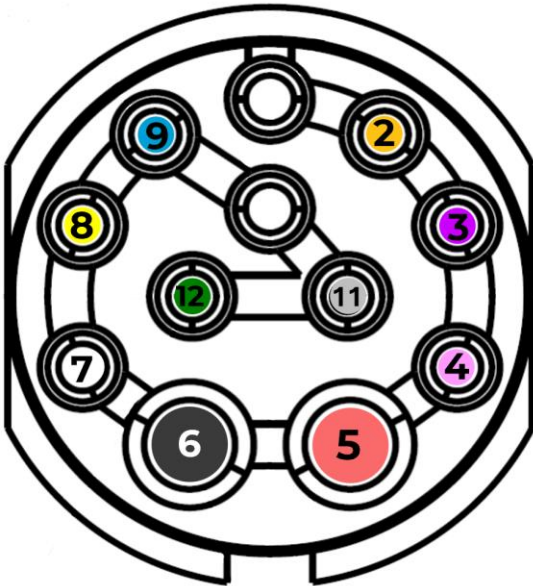

Pin	Color	Gauge	Signal
1	n/c		
2	Orange	28	MCURx
3	Purple	28	MCUTx
4	Pink	28	12V
5	Red	22	12V
6	Black	22	GND
7	White	28	GND
8	Yellow	28	NXTx
9	Blue	28	NXRx
10	n/c		
11	Mithril	28	12V
12	Green	28	GND

View From Front



***Actual Connector Image**

Note:

Silk on board is swapped, labels Tx and Rx backwards for NX UART at P3 and P4

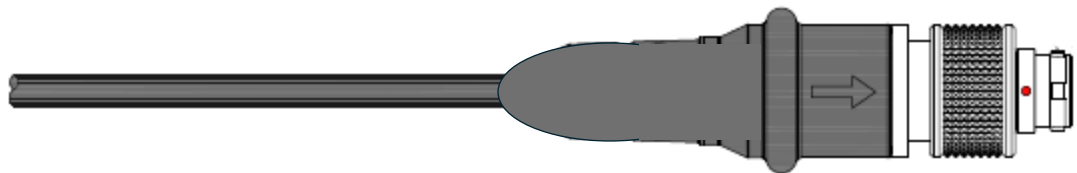

Note:

ODU Panel Mount Plug Connector
GC0WDM-PD1WMM0-000L



EDT | Engineering Design Team, Inc.

3423 NE John Olsen Avenue, Hillsboro, OR 97124 USA

<https://edt.com/>

Troubleshooting

Issue	Suggested Actions
Unit is not powering on	<p>Is the 12V power cable working? Test continuity.</p> <p>Is the recovery jumper shorting J8? Disconnect jumper or depress pushbutton. Used only for programming OS.</p> <p>Has the unit been overvoltaged? May be damaged if over 17V.</p>
Unit is getting too hot (more than about 122°F* at 75°F ambient temperature) or throttling <i>*140°F for ambient temperature of 113°F.</i>	<p>Check that there is no debris in the enclosure vents and air can flow.</p> <p>Increase airflow around/through enclosure.</p> <p>Could be a broken or defective unit.</p> <p>Reduce workload in heat.</p>
RJ45 LEDs do not light up	<p>By default they are disconnected. Contact EDT for instructions if LEDs are desired by either reaching out to your EDT point of contact or email tech@edtcom</p>
No Wi-Fi or Bluetooth	<p>Make sure Wi-Fi card is installed in E-key slot.</p> <p>RF cables connected correctly to E-Key and faceplate.</p> <p>Antenna installed.</p> <p>Check if Wi-Fi modem appears in the 'lspci' Linux tool output.</p> <p>Check if Bluetooth modem appears in the 'lsusb' Linux tool output.</p>
No GPS	<p>Install a GPS card instead of an E-Key, or use a GPS USB dongle.</p>

Appendix



EDT | Engineering Design Team, Inc.

3423 NE John Olsen Avenue, Hillsboro, OR 97124 USA
<https://edt.com/>

a HEICO company

This page intentionally left blank

Clamshell screws – Phillips head

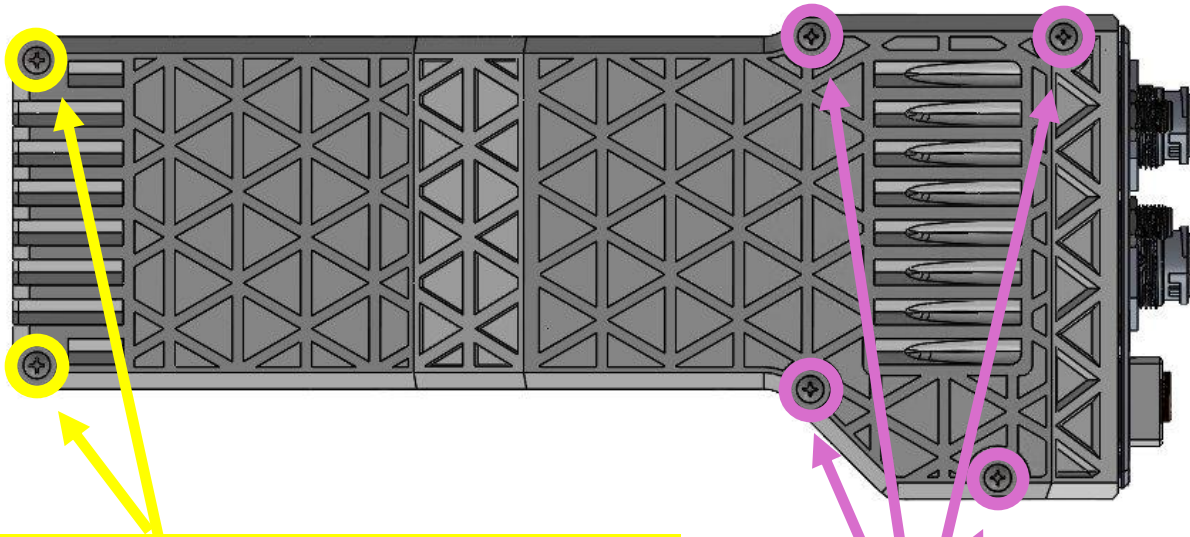

020-16189-00 Screw; PPH, M2.5x0.45, 30mm, S/S
[92000a065](#) McMaster-Carr

020-16188-00 Screw; PPH, M2.5x0.45, 35mm, S/S
[92000A202](#) McMaster-Carr

Front plate screws – T8 Torx head

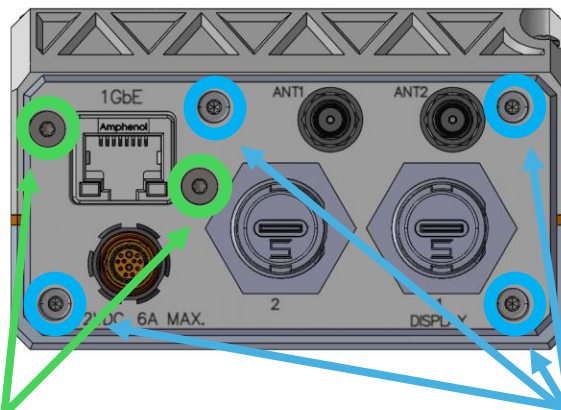

020-16190-090
Screw; Torx T8 FH, 4-40 Thread 1/4cm, S/S
[92703A205](#) McMaster Carr

020-16187-00
Screw; Torx T8 FH, M2.5x0.45, 6mm, S/S
[92703A158](#) McMaster-Carr



EDT | Engineering Design Team, Inc.
3423 NE John Olsen Avenue, Hillsboro, OR 97124 USA
<https://edt.com/>

Don't take the board out of the smaller half of the enclosure...

- But if you do, put TIM back on! (do not reuse uneven, damaged, or over-compressed TIM material)
- Route the wires carefully in the designated channel.
- Install 6x T10 Torx head screws – Be Careful to not cross thread the aluminum threads!

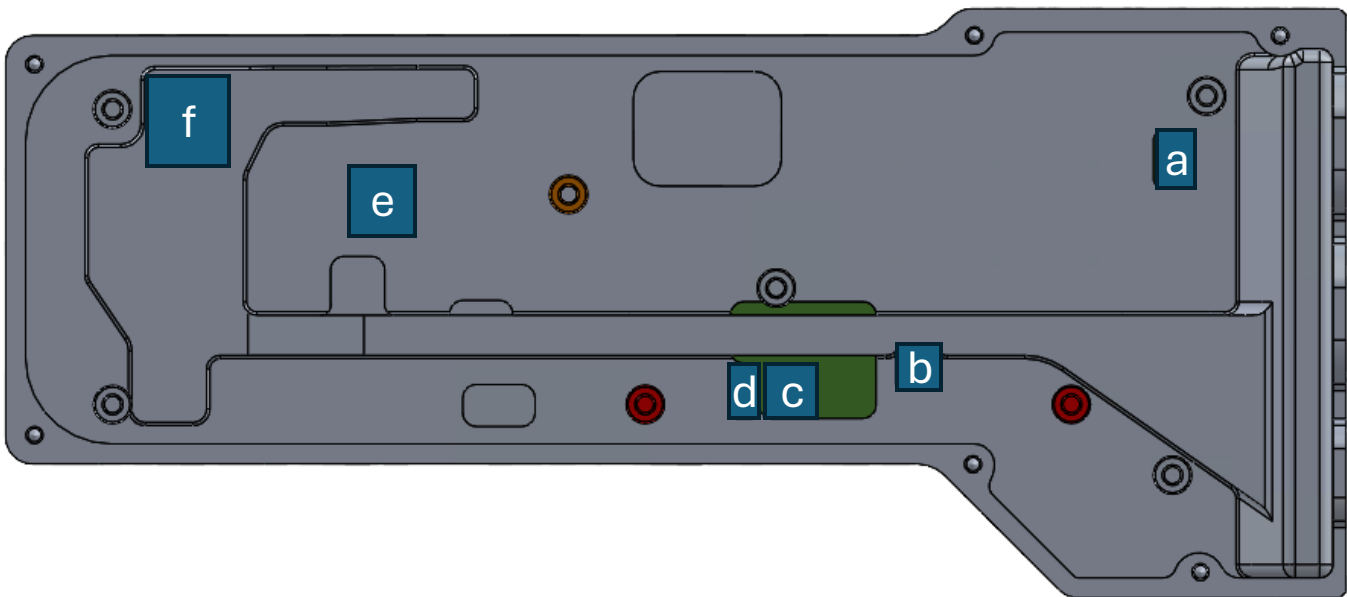

Make sure to remove plastic film from BOTH SIDES of TIM before application!!

	Thick (mm)	Dim. Mm ²
a	0.5	7 x 9
b	0.5	7 x 7
c	1	7 x 7
d	0.5	5 x 9
e	1	10 x 10
f	2.5	12 x 11

Revision Log

Date	Page	Detail
08.10.24	All	Version 1.0
08.19.25	1,12,13	Updated product image, updated product links, updated pin table.

This page intentionally left blank



EDT | Engineering Design Team, Inc.

3423 NE John Olsen Avenue, Hillsboro, OR 97124 USA
<https://edt.com/>